

GRID NA

Loc 2
Pad 640646

- INST --
- 325 - CBL, PRIUG 3PH 3C 4/0AL 15KV XLP CONC NEU
 - 60 - 4" CONDUIT, PVC
 - 6 - INSERT, LD-BREAK BUSHING 8.3
 - 6 - CONN, ELBOW #4/0 AL 8.3/14.4KV
 - 4 - SEC CONN 1/0 THRU 500 MCM
 - 1 - XFMR, 75 KVA PDMT 3PH P 7.6 208/120V

2- 4" CONDUITS,
1- 6" CONDUIT &
1- 1" CONDUIT

2- 4" CONDUITS,
1- 6" CONDUIT &
1- 1" CONDUIT

Loc 2
Pad 640646

D 7

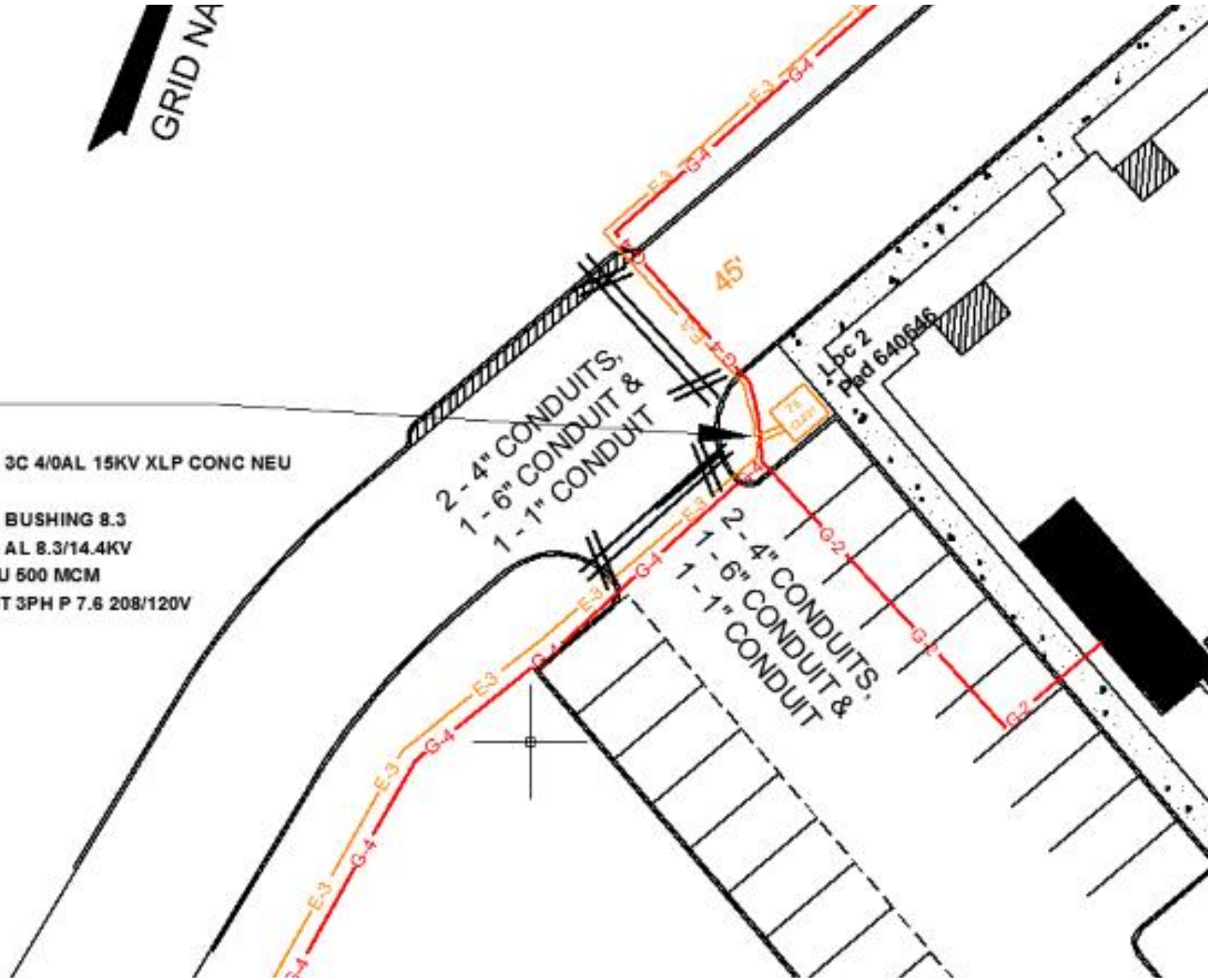

Work Orders

Tools

Projects

Find Project (F2)

- Project N10327 - New Oh Temp Se
- Project N10326 - Replace Pole Brok
- Project N10312 - Remove 2 Area Li
- Project N10310 - Replace Pole BBV
- Project N10308 - Remove Tree Guy
- Project N10296 - Install OH Sec & S
- Project N10294 - New Electric Urd,
- J896228
- Project N10292 - Replace Pole E

Locations for J896228

	Loc	Pole	Action	Joint	On Dwg	Dwg Page	Street	Comments	Orien (L/R)	Pole Size	Class	Cor-ner	Xfmr Size	Turn (L/R)	
▶	1	193227	Exis	<input type="checkbox"/>	<input checked="" type="checkbox"/>	1	oak Street, Orchard H								
	2	640646	Exis	<input type="checkbox"/>	<input checked="" type="checkbox"/>	1	Orchard Hills								
	3	640647	Exis	<input type="checkbox"/>	<input checked="" type="checkbox"/>	1	Orchard Hills								
	4	640648	Exis	<input type="checkbox"/>	<input checked="" type="checkbox"/>	1	Orchard Hills								
	5	640649	Exis	<input type="checkbox"/>	<input checked="" type="checkbox"/>	1	Orchard Hills								
	6	640650	Exis	<input type="checkbox"/>	<input checked="" type="checkbox"/>	1	Orchard Hills								
	7	640651	Exis	<input type="checkbox"/>	<input checked="" type="checkbox"/>	1	Orchard Hills								
	8	640652	Exis	<input type="checkbox"/>	<input checked="" type="checkbox"/>	1	Orchard Hills								

	Task	Qty	WTSI ID	Span From	Phase	WTSI Description	Client Description	Client Engineering Unit	Last Update
▶	I	1	2932			XARM, 8' SINGLE	XARM, 6 PIN 8' SINGLE	E 01-05-005.0	9/5/2010 1
	I	3	3128			4/0 CU TAP COV.	4/0 CU TAP COV.	E 02-02-001.0	9/30/2010
	I	1	1602			GROUND EQUIPMENT	GROUND, MGY	E 01-06-001.0	9/5/2010 1
	I	3	3569			ARRESTER, 10KV, RISER	ARRESTER, 10KV RISER	E 02-01-028.0	9/5/2010 1
	I	3	1469			CUTOUT, 100 AMP W/ DOOR	CUTOUT, 100 AMP W/ DOOR	E 02-01-021.1	9/5/2010 1
	I	1	2533			BRKT FG CO & ARR 3 PH	BRKT FG CO & ARR 3 PH	E 02-01-021.1	9/5/2010 1
	I	3	7916			AMPACT 1/0 ACSR RUN, #2 BAIL	AMPACT 1/0 ACSR RUN, #2 BAIL	E 02-01-008.0	9/5/2010 1
	I	3	3212			HLC 6-400 CU RUN, 6-4/0 CU TAP	HLC 6-400 CU RUN, 6-4/0 CU TAP	E 02-01-070.0	9/5/2010 1
	I	1	5942			RISER, 4"	RISER, 4"	E 05-01-005.0	9/5/2010 1
	I	3	6432			TERMINATOR, COLDSHRINK OUTDOOR F,	TERMINATOR, #2 15KV, COLDSHRINK	E 05-08-051.0	9/5/2010 1

Owner JS

Sort Options

- IRT
- Group
- Major

Function Keys

F2=Find EU F3=Find Pole F4=Edit EU's F8=Del Ctrl-F=Find Pole Any Project

Edit (F4)

Exit

